



60 Hz

Shallow Well Jet Pumps

1/2, 3/4, 1 and 1 1/2 HP

MODEL

JS +

J5S, J5SH, J7S, J10S, and J15S

APPLICATIONS

Specifically designed for:

- Homes
- Cottages
- Booster service

SPECIFICATIONS

Pump:

- Pipe connections:
1 1/4" NPT suction
1" NPT discharge.
- Pressure switch:
AS4FX preset
(30-50 PSI).

Motor:

- NEMA standard.
- 60 Hz.
- 1/2 – 1 1/2 HP, 115/230 V
capacitor start.
- Single phase.
- 3500 RPM.
- Built-in overload with
automatic reset.
- Stainless steel shaft.
- Rotation: clockwise when
viewed from motor end.
- UL778 listed.

Maximum temperature: 140°F.

FEATURES

■ **Compact:** Design has an integral shallow well adapter built into the casing, which eliminates the need for a separate shallow well adapter.

■ Serviceable:

- Back pullout design allows disassembly of pump for service without disturbing piping.
- Two compartment motor for easy access to motor wiring and replaceable components.
- Nozzle clean out plug in pump case.
- Corrosion resistant, engineered plastic tubing and fittings are easily removed for cleaning. Premium O-ring design fittings need only be hand tight to seal.

■ **Impeller:** F.D.A. compliant, glass filled Noryl®. Corrosion and abrasion resistant.

■ **Diffuser (Guidevane):** Bolt down diffuser provides positive alignment with impeller. Diffuser also has stainless wear ring for extended performance in abrasive conditions. F.D.A. compliant, injection molded, food grade, glass filled Lexan® for durability and abrasion resistance.

■ Tubing and Fittings:

F.D.A. compliant engineered plastic is corrosion and U.V. resistant.

■ Powered for Continuous Operation:

Pump ratings are within the motor manufacturer's recommended working limits. Can be operated continuously without damage.

■ Corrosion Resistant:

Electro-coated paint process is applied inside and out, then baked on.

■ Protected Mechanical Seal:

Special diaphragm design retains water in the casing at all times to ensure the mechanical seal can never run dry.

■ Excellent Air Handling Ability:

After initial priming the pump has the ability to re-prime itself even when air gets into the system. Pumping resumes once the water level rises above the foot valve.

SYSTEM COMPONENTS

■ Basic Pump Unit:

Includes pump with integral shallow well jet (nozzle and venturi), motor, pressure switch and tubing.

AGENCY LISTINGS



Canadian Standards Association



Underwriters Laboratories

Goulds Pumps is ISO 9001 Registered.



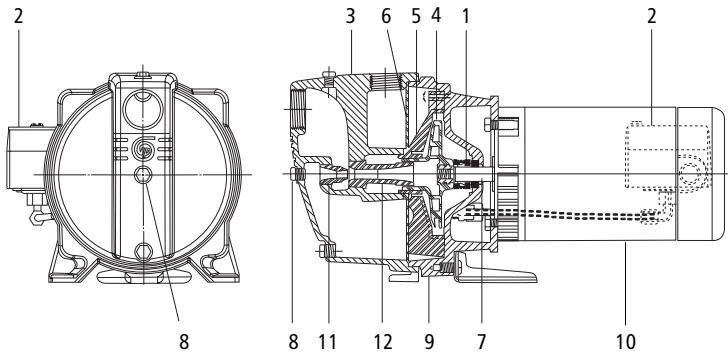

MODEL

JS +

J5S, J5SH, J7S, J10S, and J15S

COMPONENTS

Item No.	Description
1	Mechanical seal
2	Pressure switch
3	Casing
4	Impeller
5	Diffuser (Guidevane)
6	Diaphragm
7	Stainless steel shaft
8	Nozzle clean-out plug
9	Motor adapter
10	Motor
11	Nozzle
12	Venturi (diffuser)

DIMENSIONS AND WEIGHTS

Model	J5S	J5SH	J7S	J10S	J15S
Wt. (lbs.)	43	43	47	50	60
Length	17 1/4	17 1/4	18 1/4	18 3/4	19 1/4
Width	9 5/8				
Height	8 3/4				
HP	1/2	1/2	3/4	1	1 1/2
"L" Max.	8 1/2	8 1/2	9 1/2	10	10 1/2

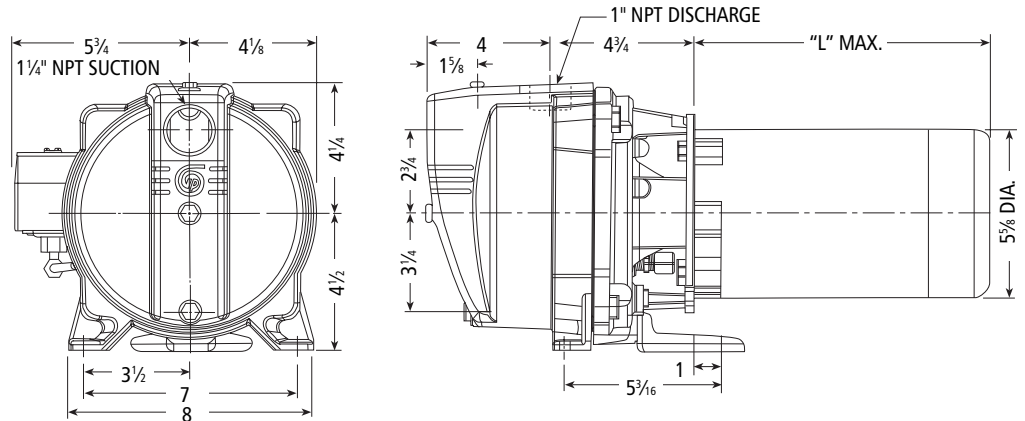

(All dimensions are in inches and weights in lbs. Do not use for construction purposes.)

SHALLOW WELL PERFORMANCE RATINGS

HP/Model	1/2 HP – J5S					1/2 HP – J5SH					3/4 HP – J7S					1 HP – J10S					1 1/2 HP – J15S									
Nozzle	AN017					AN019					AN018					AN018					AN022									
Venturi	AD3332					AD3328					AD3336					AD3339					AD3342									
Total Suction Lift (feet)	Discharge Pressure – PSI						Discharge Pressure – PSI						Discharge Pressure – PSI						Discharge Pressure – PSI						Discharge Pressure – PSI					
	20					Max. Shut off (PSI)	30					Max. Shut off (PSI)	40					Max. Shut off (PSI)	50					Max. Shut off (PSI)	60					Max. Shut off (PSI)
	Gallons per minute						Gallons per minute						Gallons per minute						Gallons per minute						Gallons per minute					
5	17.5	16.5	10.2	5.0	63	11.5	11.3	11.0	7.7	4.8	83	21.3	18.3	12.5	6.6	70	24.8	24.4	16.6	9.9	74	26.6	26.3	25.0	15.6	80				
10	15.7	14.4	9.2	4.3	61	10.3	10.0	9.6	7.0	4.2	81	18.8	17.3	11.3	5.0	68	22.9	22.2	15.8	8.6	72	24.7	24.3	22.6	13.9	77				
15	13.7	12.5	8.0	3.6	59	8.8	8.6	8.3	6.3	3.7	79	16.4	15.5	9.6	3.7	66	19.8	19.5	13.8	6.9	70	21.6	21.5	20.4	12.9	75				
20	11.5	10.4	7.1	2.3	57	7.0	7.0	6.8	5.8	3.2	76	13.6	13.2	8.3	2.0	63	16.6	16.6	12.2	5.6	67	18.1	18.0	17.6	12.0	73				
25	8.7	8.6	6.2	1.3	54	5.3	5.2	5.2	5.0	2.8	73	10.0	9.9	6.4	1.0	59	12.5	12.4	10.4	3.6	65	14.0	14.0	14.0	10.1	71				